



Graffitigard™ 4PLUS Film Installation and Removal Guide for Tailor-Made Cut-To-Size Shapes

Saint-Gobain Graffitigard™ 4PLUS anti-vandalism film is a durable, optically clear, proven solution to quickly and cost-effectively eradicate vandalism repeatedly with a single application. Vandalized film can be quickly and easily removed refreshing the surface in seconds to protect from future attacks.

This bulletin focuses on tailor-made, cut-to-size shapes, that include a state-of-the-art tabbing system, to facilitate peeling away layer by layer.

The focus of this bulletin will be on the recommended application technique on glass and non-porous surfaces.

Tools required:

1. Spray bottle or pressure sprayer
2. Slip aid
3. Lint free towels
4. Non-abrasive scrub pad
5. Razor scraper
6. Glass cleaning squeegee
7. Five-way tool or hard card
8. Mounting solution removal squeegee
9. Pick tool

1 Completely clean the glass surface

- a. Wash surface with mounting solution and non-abrasive scrub pad, and squeegee off excess solution. Always perform a test to ensure you do not damage the surface.
- b. **Glass surfaces only** - Wet again with solution and scrape entire surface of glass with razor scraper.
- c. Wet surface and squeegee again.
- d. Wipe edges carefully with lint free towels to remove excess water and dirt.
- e. Make certain all loose dirt is removed from the surface and frame; repeat cleaning process if necessary.

Precautions: OEM glass surfaces may contain a coating applied for ease of handling or protection that must be completely removed prior to the installation of film. Follow the manufacturers recommendations on proper removal.

2 Release liner removal

- a. The Graffitigard 4PLUS film adhesive is pressure sensitive and sticks to anything it comes in contact with. It is protected with a disposable release liner that must be removed before application.
- b. Apply tape to one corner of film. Place a second piece of tape on the opposite side of the first piece.
- c. Pulling these tape pieces away from each other will begin the removal of the release liner from the mounting adhesive.

- d. Once removal has begun, immediately begin spraying the exposed adhesive with wetting solution. Continue spraying adhesive surface while removing entire piece of release liner.
- e. With the adhesive surface exposed, spray adhesive and window one final time to ensure that both surfaces are fully saturated.

3 Film application

- a. Hold the film at the upper corners being careful not to allow the film to contact any other surfaces. Place the film on window with adhesive side against the glass.
- b. The application solution will allow movement of the window film on the glass.
- c. Slide the cut-to-size film in position leaving 1/8" to 1/4" gap between the film and the frame or gasket.
- d. Spray solution on the film, starting at the center of the film; hold the film in place with your free hand and tack the film with a vertical squeegee stroke (1) displayed in Diagram 1.
- e. Squeegee following the strokes in the diagram to tack it to the window. Squeegee strokes should overlap your previous pass 50% to 75% to prevent water trails.

TIP: Proper use of the squeegee is essential to achieving the professional results you want. Use both hands and your body weight to your advantage and lean into the squeegee as you push. Overlap the previous pass by 50% each time. As you squeegee, angle the squeegee blade slightly away from the

previous path. Use slow strokes, applying a good amount of even pressure through the entire pass. The squeegee blade itself should be angled 30 to 45 degrees from the glass surface. The goal is to remove as much mounting solution in a single pass..

Diagram 1

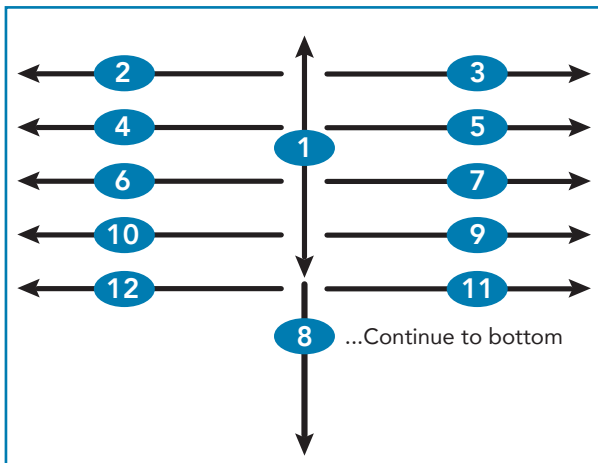

Note: Thicker films require thicker heavy duty squeegees. The hard rubber blades transfer more of your weight, or input, directly to the pressure-sensitive surface for a more consistent evacuation of the mounting solution. If a blade becomes nicked or worn it reduces the squeegee's effectiveness, so replace it right away. Saint-Gobain highly recommends an Unger handle with 6" channel & Blue Power Max Blade (catalog #0576 + 0578-6) or Aluminum Squeegee (catalog #0608). These tools can be purchased through filmhandler.com.

5 Finishing

Using a five-way tool or hard card wrapped in a lint free towel systematically work around the window to dry the edges of the film and frame. Rotate towel frequently to reduce the chance of scratching due to contamination from the frame and maximize solution absorption.

Diagram 2

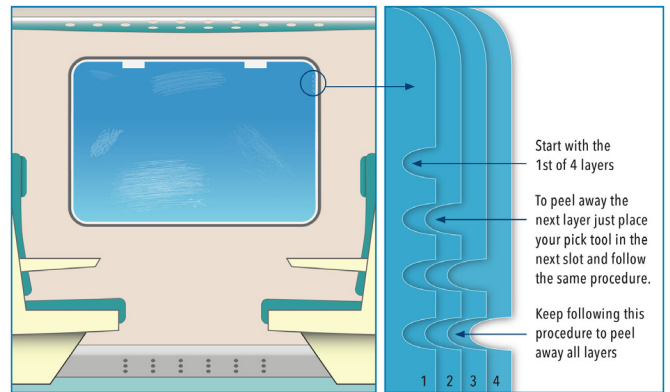

6 Removing vandalized film

- Each tailor-made, cut-to-size shape has a tabbing system (Diagram 2).
- Use a pick tool to carefully peel the 1st single layer of the film from the underlying surface. The pick tool can be purchased through filmhandler.com.
- Position the pick tool in the first notch in order to peel away the 1st of 4 layers. Gently press the point of the pick tool along the edge of the notch and peel a few centimeters of film (enough to grab with your finger tips).
- Slowly peel the film with your hands along the shortest length of the window at an angle between 120-150°.

You have just removed the first of 4 layers. To peel away the next layer just place your pick tool in the next slot and follow the same procedure. Keep following this procedure to peel away all layers.

ENVIRONMENTAL CONDITIONS: Film may be removed at any time however; removing film in extremely cold or hot conditions can cause a change in the mechanical properties of the adhesive resulting in unwanted adhesive transfer to the surface the film was applied to. The ideal conditions exist when the surface temperature is above 15° C but not higher than 35° C.



Authorized distributor using Racing Optics technology.

Laminated Tearoff System is exclusively licensed by Racing Optics, Inc. covered under U.S. Letters Patent No. 6388813, 6536045, 6847492, and 7184217. Europe 1502146, 1517791 Canada 2386043. Other U.S. and foreign patents pending.

www.custom-films.com

Saint-Gobain Innovative Materials Belgium SA/NV
Solar Gard European Headquarters:
Avenue Einstein 6 1300 Wavre, Belgium
Contact address: Karreweg 18, 9870 Zulte, Belgium
E: info.emea@solargard.com
T: +32 (0)9 240 95 66

PDF0502SGG4PLUSIGINT 02/19
© Copyright 2019, Saint-Gobain Performance Plastics
and/or its affiliates • All Rights Reserved • www.solargard.com

Please recycle

SAINT-GOBAIN